

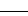

ELEVAÇÃO FRONTAL
Esc. 1/100



QUANTITATIVO		
SÍMBOLO	ITEM	QUANTIDADE
	Alvenaria existente	
	demolição e construção	7,59 m ²
	viga	h= 25 cm
	Alvenaria	75,56 m ³



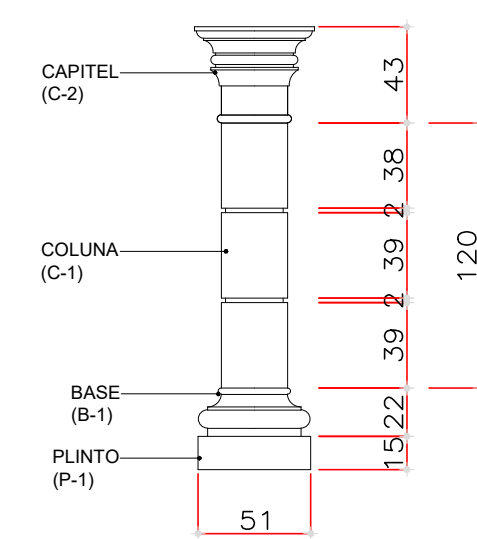

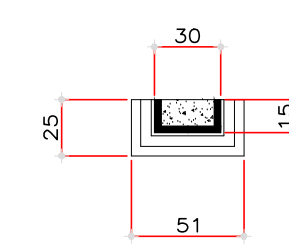
PILARES DO MURC
Esc. 1/20

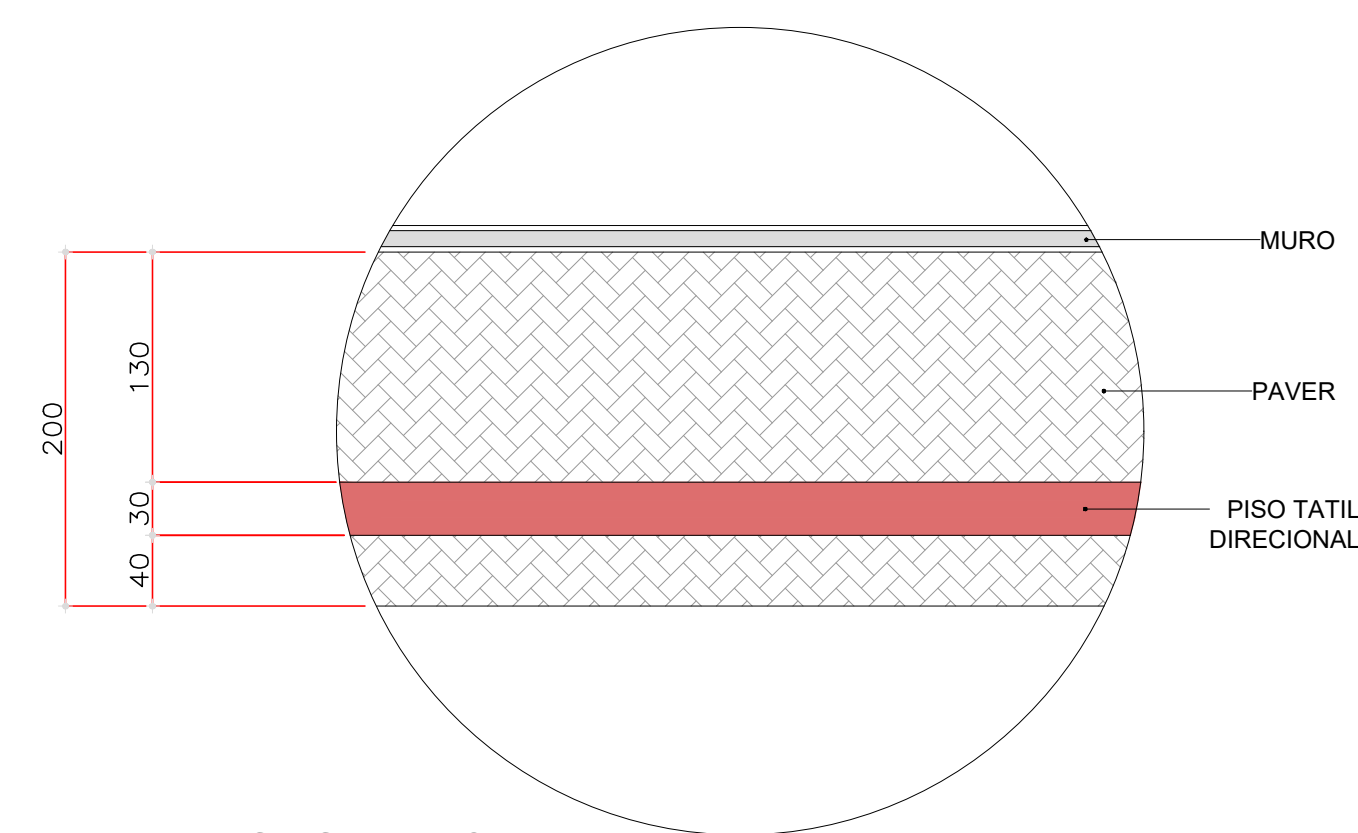

PLANTA



DETALHE CALÇAMENTO

QUANTITATIVO			
SÍMBOLO	MATERIAL	LOCAL	QUANTIDADE
	Paver	Externo	272,98 m²
	Tessl	Passeio	49,80 m²

APROVAÇÃO

REFORMA DO CEMITÉRIO MUNICIPAL

PROPRIETÁRIO

LOCAL

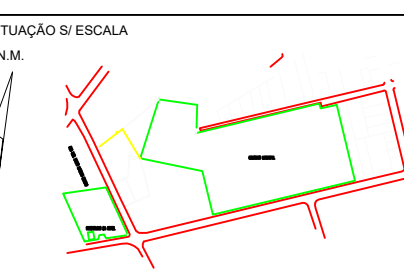

MURO/ PILARES - 253,98 m2

PROGETTO

ERALDO GOMES MEDERICO JUNIOR
INGENHEIRO CIVIL, CREA 21.699/D PR

03/07

ESCALA

1

DATA